



## Customized Pallet Flow Roller Down Pallet Racking For Two Aisle Galvanized / Powder Coating

### Our Product Introduction

for more products please visit us on [warehouse-rackings.com](http://warehouse-rackings.com)

#### Basic Information



#### Product Specification

- Model NO.: QF-Gravity Pallet Rack
- Type: Pallet Racking
- Mobility: Fixed
- Height: 5-15m
- Closed: Semi-closed
- Development: New Type
- Serviceability: Common Use
- Color: Customized
- Lead Time: 20 Days
- Raw Material: Q235B
- Surface Treatment: Galvanized/Powder Coating
- Transport Package: Standard Export Packing
- Specification: Customized
- Trademark: Customized
- Origin: China



#### More Images

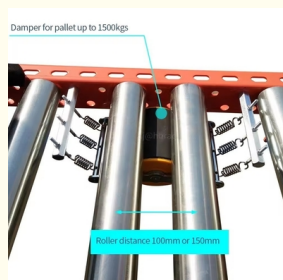
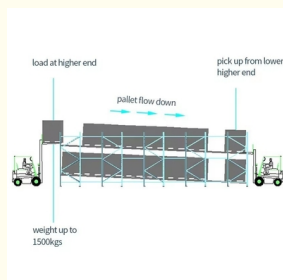

## Product Description

**Whatever you need, Qifei has all the products and solutions, to make the most out of every section of available space in your storage area.**

**If you don't know what you're looking for, just contact us.**

### Product Description

***Pallet Flow Racking, or 'Pallet Live Storage' is ideal if you operate a First-in, First-out (FIFO) goods storage setup.***

***With this system you can use up to 60% less space than if you were to use conventional pallet racking.***

Our Pallet Flow system offers a dynamic storage solution with integrated conveyor modules to suit most pallet types and sizes. It's well-suited for the drinks industry or as a buffer storage facility in manufacturing.

**Dimensions**  
1000mm (1 lane)  
2000mm (2 lanes)  
3600mm (3 lanes)  
Block Height: Up to 13500mm

Channel Depth: Up to 15 pallets deep

**Loading** Pallet Weight: Up to 1500kg

Uprights: Pre-galvanized

**Finish** Beams: Pre-galvanized or painted

Accessories: Pre-galvanized or painted

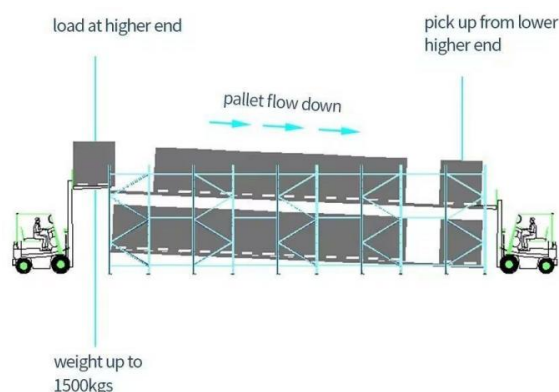

### Can be customized to your requirements

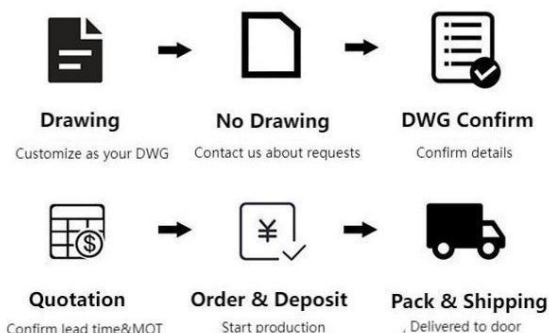

### Required information for customized quote

- 1, The AUTOCAD drawing or draft drawing of warehouse or racking.
- 2, Length, Height, and Width of the warehouse.
- 3, Layers of the racking
- 4, Pallet size.
- 5, Max weight of pallet with cargo on.
- 6, Color requirement.

### Detailed Photos

Pallets travel smoothly on full-width or twin-track rollers. While the front pallet is removed on the front side of the rack, the rear pallet is held back. Pallet movement is always safe and smooth thanks to automatic braking, along with a combined load guide and end stop unit.

### Pallet Flow Racking offers the following features and benefits as standard:

Dedicated load and retrieval means only two forklift truck aisles are required  
Uses up to 60% less floor space than conventional pallet racking  
FIFO operation - for automatic stock rotation  
Faster, more efficient warehouse picking speeds

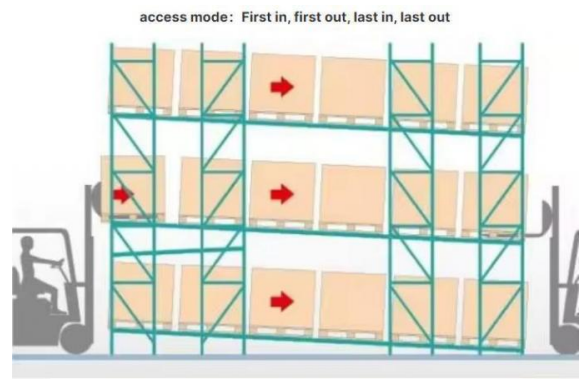
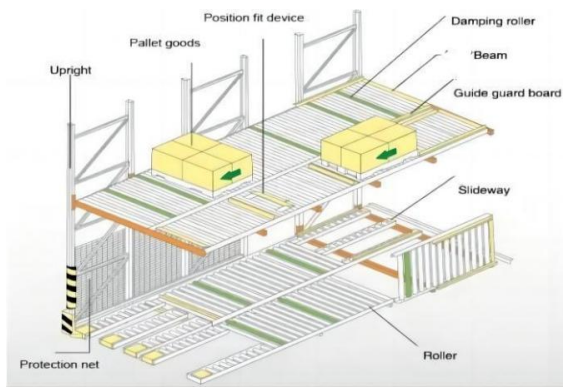

By using roller system or pallets with roller and under the influence of gravity, "first in and first out" for the goods is achieved



The surface is sprayed with thermo-setting powder, which is beautiful and elegant



The installation and connection of the upright post and the cross beam are simple and stable.



When the baffle is tilted, the goods at the end are separated from the goods behind.



The frame and roller are easy to install and adjustable.



The goods slide smoothly without deviation.

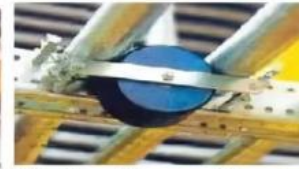

Adjust the sliding speed of goods through the pull rod.

## Customer Site







Packaging &  
Shipping

## Packing



Package for Upright Frame



Package for Beam



Loading for Beam



Loading for Upright Frame



Loading for Wire Mesh Cage

## Shipping



MOT AS YOUR REQUEST



AIR FREIGHT FOR URGENT  
Transit time:5-7 days



OCEAN SHIPPING NORMALLY  
Transit time:15-40 days

Company

Profile

**Welcome to visit our company**

## Jiangsu Qifei Intelligent Storage Equipment Co., Ltd



Established in 2020, is one of the leading manufacturer specialized in industrial warehouse storage equipment



Main products are heavy/medium/light duty rack, cantilever rack, mezzanine floor, drive in rack, and so on.



We aim to provide cost-effective and space utilization storage solutions for all customers worldwide



## FAQ

### Q: Are you manufacturer or trading company?

A: We are experienced manufacturer in the warehouse storage industry.

### Q: How is your delivery time?

A: Generally, it is within 20 days against formal order and deposit. It also depends on other factors such as order quantity.

### Q: What is the payment term?

A: T/T 30% as deposit, and 70% before delivery. We'll show you the photos of the products and packages before you pay the balance.

### Q: What is your terms of delivery?

A: EXW, FOB

### Q: Are samples available?

A: Yes, We can supply the sample if we have ready parts in stock, but the customers have to pay the sample cost and the courier cost.

### Q: What is the minimum order quantity?

A: Generally, MOQ is 10sets.

### Q: Can I make my own brand and designed products?

A: Yes, we do both OEM and ODM, so you can make your own product with your own logo.

### Q: Where is your factory? Can I visit it?

A: Our factory located in Nanjing, Welcome to visit our factory. We can arrange pick-up from the airport or train station for you.

### Q: What is the material being used for your products?

A: Mild steel Q235.

### Q: I don't have drawing or picture available for the products, could you design it for me?

A: Yes, we can make the best suitable design for you but need to know more details.

### Q: Do I get any guarantee from your company?

A: 3 years warranty

### Q: How do you make our business long-term and good relationship?

A: Quality makes trust and reputation, plus competitive price to ensure our customers benefit ;



**Jiangsu Qifei Intelligent Storage Equipment Co., Ltd.**



+86-15161451461



sharonyan@qifeirack.com



warehouse-rackings.com

Add: #739 Dixiu Road Jiangning District Nanjing China